



## UNCW VISITORS – CAMP LEJEUNE BASE ACCESS PROCEDURE

### Directions to the Camp Lejeune Visitor's Center from the South

- Follow Hwy. 17 North to Jacksonville, NC. After passing MCAS New River's front gate, take the bypass toward Morehead City/Swansboro and Camp Lejeune Main Gate (to Hwy 24 East).
- From Hwy 24 take exit toward Camp Lejeune's Main Gate. Stay in the far right lane and exit at the **Visitor's Center** located just before the guard post.
- Advise the **Visitor's Center** personnel that you are a guest of UNCW and on their guest list for the day.
- At the **Visitor's Center** you will receive your temporary base pass (documentation requirements listed below).
  - **Proof of current auto insurance**
  - **Current vehicle registration**
  - **North Carolina REAL Driver's License/ID**
    - If you hold a N.C. Real Driver's License no other Identification is required (identifiable by the **gold star** in the top right corner)
    - If you **do not** have a N.C. Real Driver's License, below are other options available.
- **Additional Base Access Options**
  - **Option I**
    - **North Carolina Driver's License with an Alternate Form of ID**

If you hold a North Carolina driver's license which **is not** the new **N.C. Real ID/License** (identifiable by the **gold star** in the top right corner) you will be required to have additional documentation in addition to your driver's license. Below are the acceptable alternate forms of identification to gain access through the Visitor's Center.

      - **U.S. Passport**
      - U.S. Passport Card
      - U.S. Coast Guard Merchant Mariner Card
      - Personal Identity Verification (PIV) Card
      - Personal Identity Verification – Interoperable (PIV-I)
      - U.S. State Department Driver's License
      - Veteran's Health Identification Card (Issued by the U.S. Department of Veterans Affairs)
      - U.S. Permanent Resident Card (Form I-551)
      - U.S. Certificate of Naturalization or Certificate of Citizenship (Form N-550)
      - Department of Homeland Security Employment Authorization Document (Form I-766)

## Option II

- **North Carolina Driver's License Without an Alternate Form of ID (listed above)**
  - If no alternate form of ID is presented, a person requesting access to base must be escorted by a sponsor who meets installation requirements. UNCW has a staff member who meets these qualifications.
- After you receive your temporary Visitor's pass proceed through the Front gate and continue straight on Holcomb Blvd. until you reach the first stop light and turn right onto Brewster Blvd.
- Continue on Brewster Blvd. to the first stop light and turn left onto Stone Street. The John A. Lejeune Building (Bldg. 825) is on your right after you pass Lejeune High School and the Stone Street Youth Pavilion.

## Important Reminders When Driving On Base

- Cell Phones: You may not use your cell phone on base while driving unless you have a hands-free system. Violation of this law will result in a ticket, court date, and possible removal of base driving privileges.
- Speed Limit: Failure to drive the speed limit on base may result in a ticket, visit to traffic court, and possible removal of base driving privileges.

## John A. Lejeune Education Center

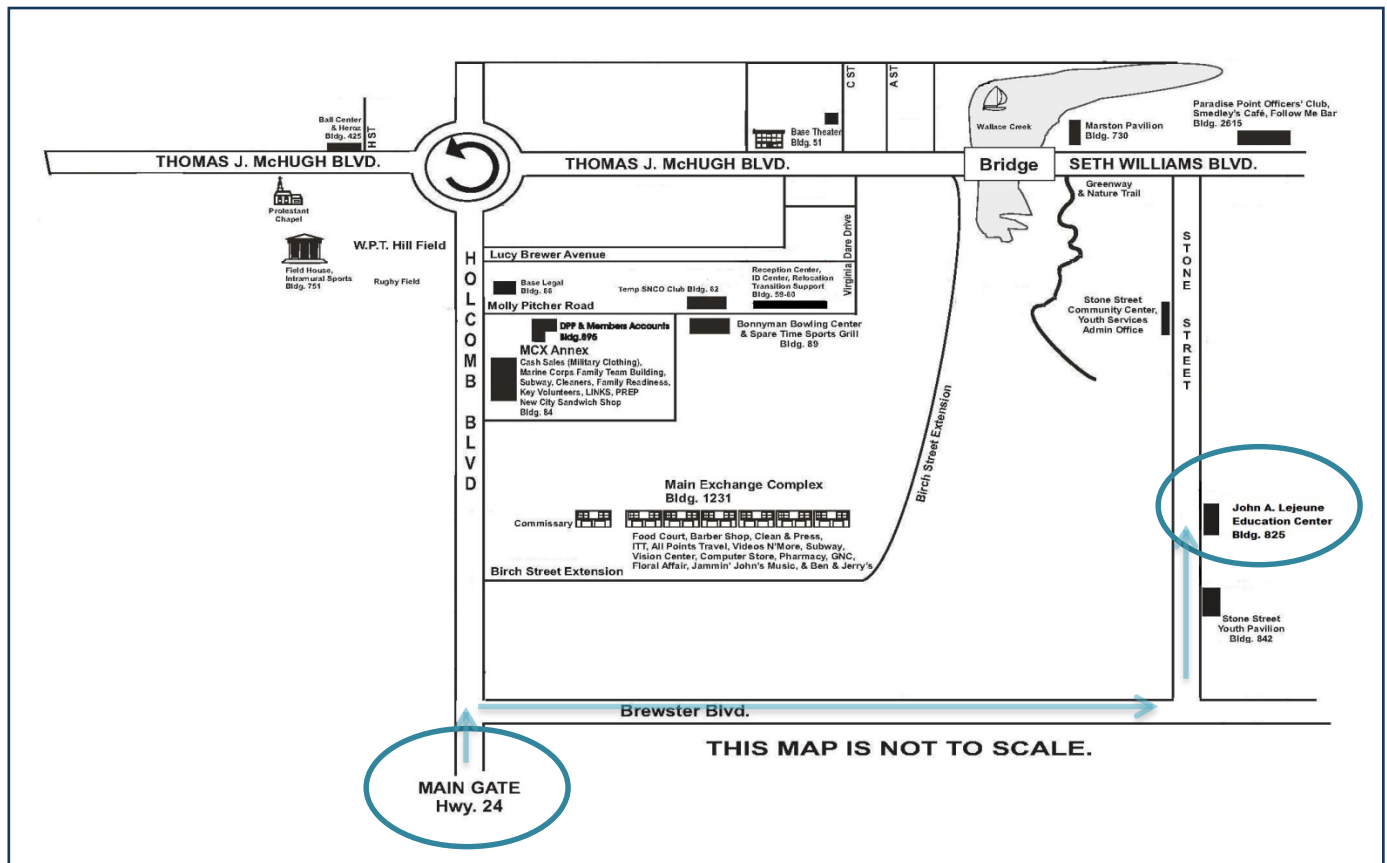

# Camp Lejeune Classroom Locations

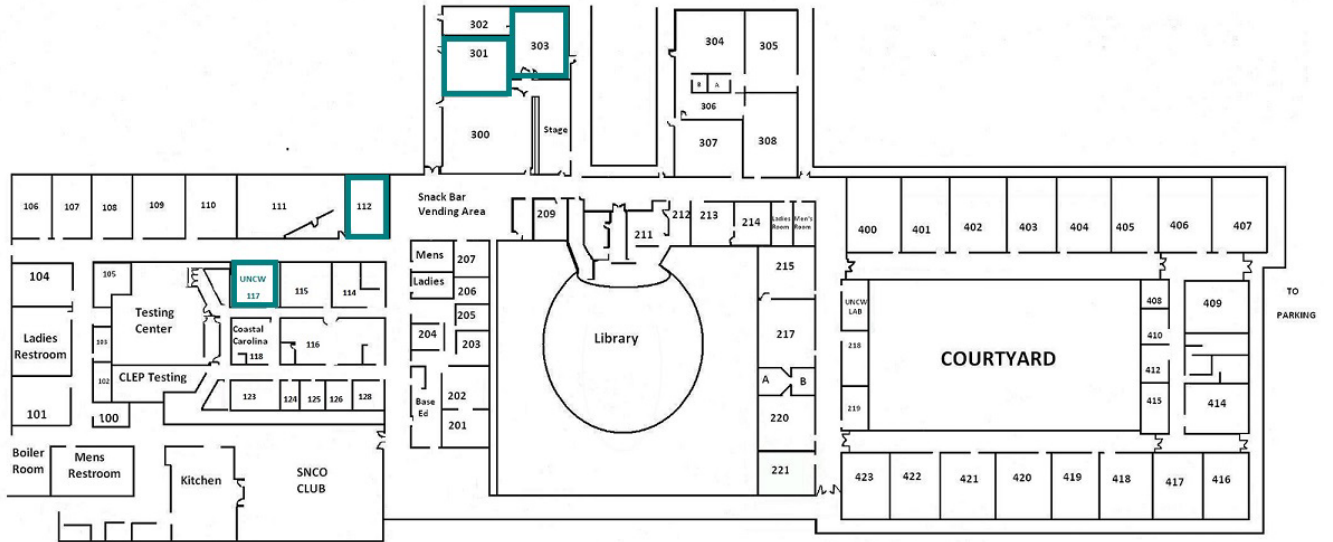

JOHN A. LEJEUNE EDUCATION CENTER  
BUILDING 825