

Watson College of Education Faculty, Staff and Room Directory

Name	Phone	Room	Name	Phone	Room	Name	Phone	Room
Adams, Krysti	Ms. 2-3363	238	Hunt, Lisa	Ms. 2-3179	323	Schlichting, Kathleen	Dr. 2-7786	249
Barreto, Daisyane	Dr. 2-7600	345	Johnson, Brenna	Ms. 910-355-2311		Senta, Amy	Ms. 2-2851	268
Batten, Kathryn	Ms. 2-2856	127	Jones, Allison	Dr. 2-2194	211	Sheerer, Marilyn	Dr. 2-2535	365
Bennet-Smith, Kiesha	Dr. 2-2095	RL2061	Jones, Meredith	Dr. 2-3724	267	Sikma, Lynn	Dr. 2-7287	208
Bellas, Traci	Ms. 2-3363	128	Jurich, Chuck	Dr. 2-7201	234	Siko, Janice	Ms. 2-3354	327
Best, Lori	Ms. 2-7281	FA 123	Kermani, Hengameh	Dr. 2-4182	220	Smith, LeAnne	Ms. 2-7348	111E
Blanke, Candace	Ms. 2-4173	156	Kezios, Sue	Dr. 2-2118	MacMillan	Smith, Robert	Dr. 2-4076	354
Brinkley, Brian	Mr. 2-3731	129	Knight, Jennifer	Ms. 2-4246	157	Sobul, Emily	Ms. 2-0518	238
Cardenas, Jes	Dr. 2-2919	213	Koonce, Wendy	Ms. 2-2939	CIE	Sterrett, William	Dr. 2-4174	160
Caropreso, Edward	Dr. 2-7830	317	Kozloff, Martin	Dr. 2-7286	FA 177	Stocker, James	Dr. 2-2739	277
Carr, Marsha	Dr. 2-2913	Remote	Kubasko, Dennis	Dr. 2-7817	FA 125	Swafford, Jeanne	Dr. 2-2741	310
Carroll, Amy	Ms. 2-4017	FA 126	Lane, Diane	Ms. 2-4172	324	Szech, Laura	Dr. 2-2036	233
Cayton, Misty	Ms. 2-3192	326	LaNunziata, Lou	Dr. 2-3368	212	Taylor, Amy	Dr. 2-2673	218
Chambers, Alex	Dr. 2-0614	260	Lewis, Somer	Ms. 2-7244	156	Thompson, Candace	Dr. 2-2648	341
Chen, Sue-Jen	Dr. 2-7920	314	Liao, Christine	Dr. 2-3556	240	Townsend, Courtney	Ms. 2-7645	130
Childs, Joy	Ms. 2-2740	324A	Lynn, Allen	Mr. 2-2483	379	Walker, Morgan	Ms. 2-7783	
Clark, Heddy	Ms. 2-3639	MacMillan	McClure, Kevin	Dr. 2-7819	382	Walser, Tamara	Dr. 2-4175	366
Clark, Tammy	Ms. 2-7938	346B	McKnight, Logan	Ms. 2-2796	150B	Wasserberg, Martin	Dr. 2-2917	270
Cockrell, Kimberly	Ms. 2-3971	MacMillan	McKoy, Tonia	Ms. 2-2856	127	Webb-Dempsey, Jaci	Dr. 2-2161	FA131
Conklin, Sheri	Dr. 2-7952	350B	McNulty, Carol	Dr. 2-3867	FA 189	Wiseman, Cindy	Ms. 2-3360	150A
Crawford, Elizabeth	Dr. 2-2916	FA190	Moody, Amelia	Dr. 2-2580	210	Zaccor, Karla	Dr. 2-2890	247
DeGennaro, Donna	Dr. 2-7551	372	Moran, Erin	Ms. 2-2992	CMS1053			
Demspey, Van	Dr. 2-3354	328	Morge, Shelby	Dr. 2-7501	265	Academic Advising		111
DeVita, James	Dr. 2-3953	376	Movahedazarhouligh, Sara	Dr. 2-0613	274	Assistive Technology Lab		351
Durrington, Vance	Dr. 2-2741	310	Muhlstein, Harris	Mr. 2-2640	CMS	Associate Dean, Academic & Student Affairs		308
Ertzberger, Jeff	Dr. 2-7670	237	Newcity, Melissa	Ms. 2-7745	111	Associate Dean, Teacher Ed. & Outreach		160
Evans, Dianne	Ms. 2-4142	308	Nguyen, Tina	Ms. 2-3081	324	Center for Assistive Technology		Combs House
Finley, Susan	Ms. 2-2672	131	Okello, Wilson	Dr. 2-3786	373	CESTEM		Combs House
Fox, Kathy	Dr. 2-3240	219	Ousley-Exum, Denise	Dr. 2-7175	340	Curriculum Materials Center		127
Fowler, Kerri	Ms. 2-3040	378	Oxendine, Symphony	Dr. 2-3430	353	Dean's Office		326
Garrett Dikkers, Amy	Dr. 2-2915	307	Pappamihiel, Eleni	Dr. 2-2746	349	Distance Learning Classroom		214
Gaston, Jasmine	Ms. 2-7952	MacMillan	Parker, Michele	Dr. 2-2292	336	Distance Learning Classroom		266
Geczi, Nicole	Ms. 2-3561	147	Pastore, Raymond	Dr. 2-2912	339	Distance Learning Classroom		226
Geiss, Gianna	Ms. 2-3287	Combs	Pena, Tracy	Ms. 2-7615	346A	Distance Learning Classroom		337
Giammaria, Mary Jo	Ms. 2-4296	126	Pierce, Phyllis	Ms. 2-4001	278	Education Lab		130
Gill, David	Dr. 2-4293	371	Powell, Brian	Ms. 2-7052	238	EYC Classroom		214
Glowa, Stephanie	Ms. 2-3086	150C	Rankin, Allison	Ms. 2-2291	111B	Lecture Hall		162
Goodnight, Crystalyn	Dr. 2-2658	215	Reid-Griffin, Angelia	Dr. 2-7176	375	MarineQuest		CMS
Guggenheimer, Maggie	Ms. 2-2416	350A	Richter, Sharon	Dr. 2-3507	259	MIT Lab		368
Hafey, Michelle	Ms. 2-3168	MacMillan	Rivenbark, Jessica	Ms. 2-7115	FA132	PDS Office		156
Hanson, Erika	Ms. 2-7357	111D	Robertson, Janna	Dr. 2-4036		Science Lab		223
Hargrove, Tracy	Dr. 2-7395	244	Robinson, Kerry	Dr. 2-3652	384	Technology Assistance		238
Heath, Dean	Mr. 2-3087	113	Roney, Kathy	Dr. 2-7195	262	Young Adult Transition Classroom		108
Higgins, Heidi	Dr. 2-2674	271	Roseboro, Donyell	Dr. 2-3283	348	Youth Programs		MacMillan
Hilburn, Jeremy	Mr. 2-2897	241	Ryan, Caitlin	Dr. 2-3546	365			
Hooker, Steven	Dr. 2-7577	308	Ryder, Andrew	Dr. 2-7318	377			
Housand, Angela	Dr. 2-3361	318	Sanchez, Marta	Dr. 2-7174	344			
Howell, Laurie	Ms. 2-4171	272	Scanlon, Deirdre	Ms. 2-2939	Combs			

CMS = Center for Marine Science

FA = Friday Annex

MacMillan = MacMillan Modular

Watson College of Education at the University of North Carolina Wilmington

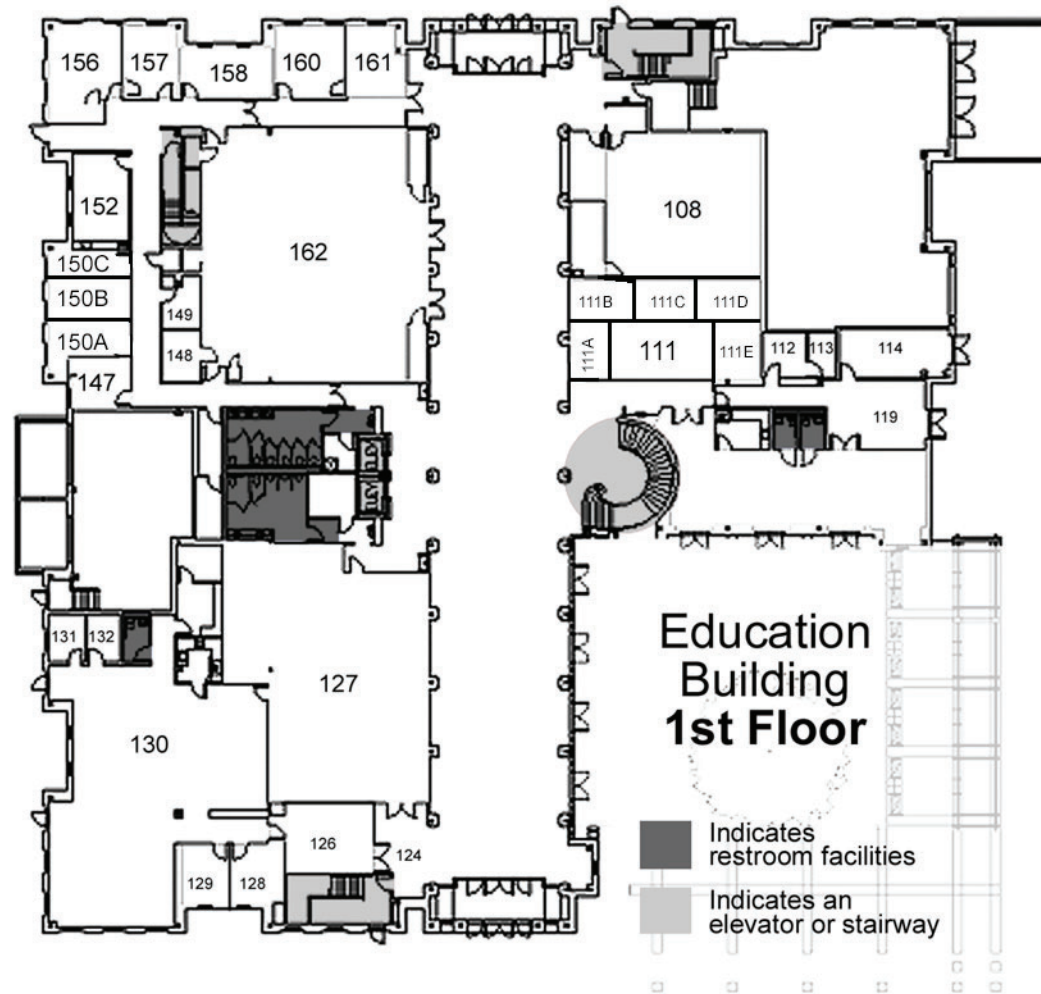

Watson College of Education at the University of North Carolina Wilmington

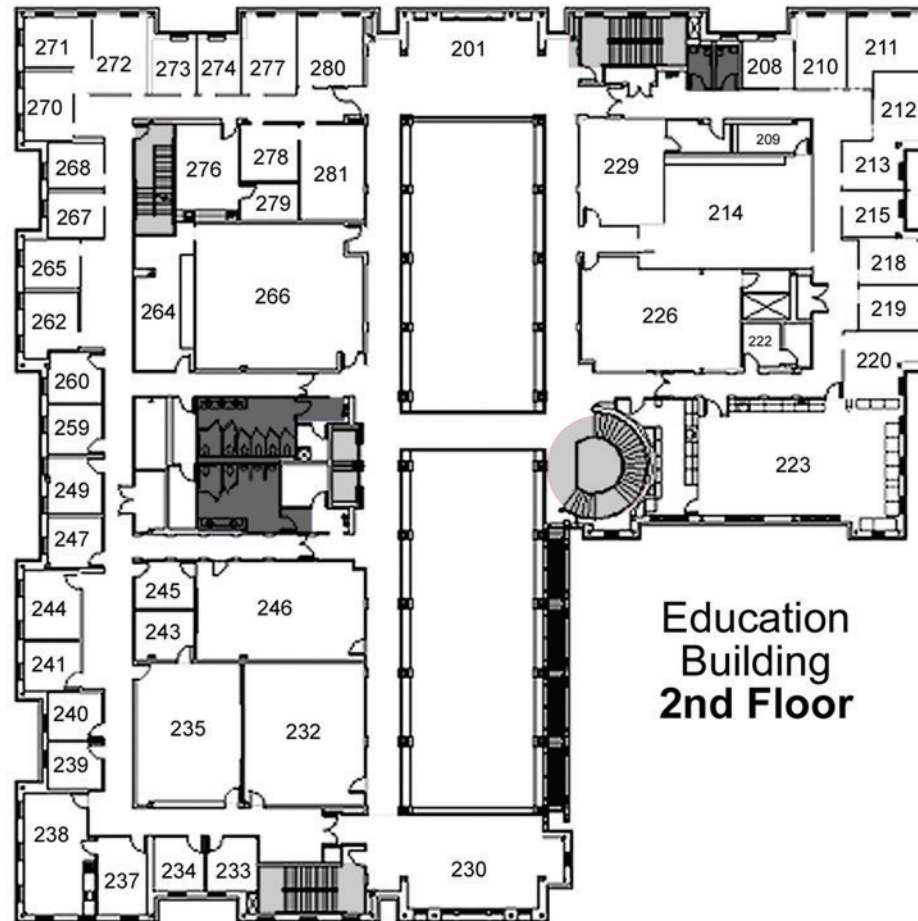

Watson College of Education at the University of North Carolina Wilmington

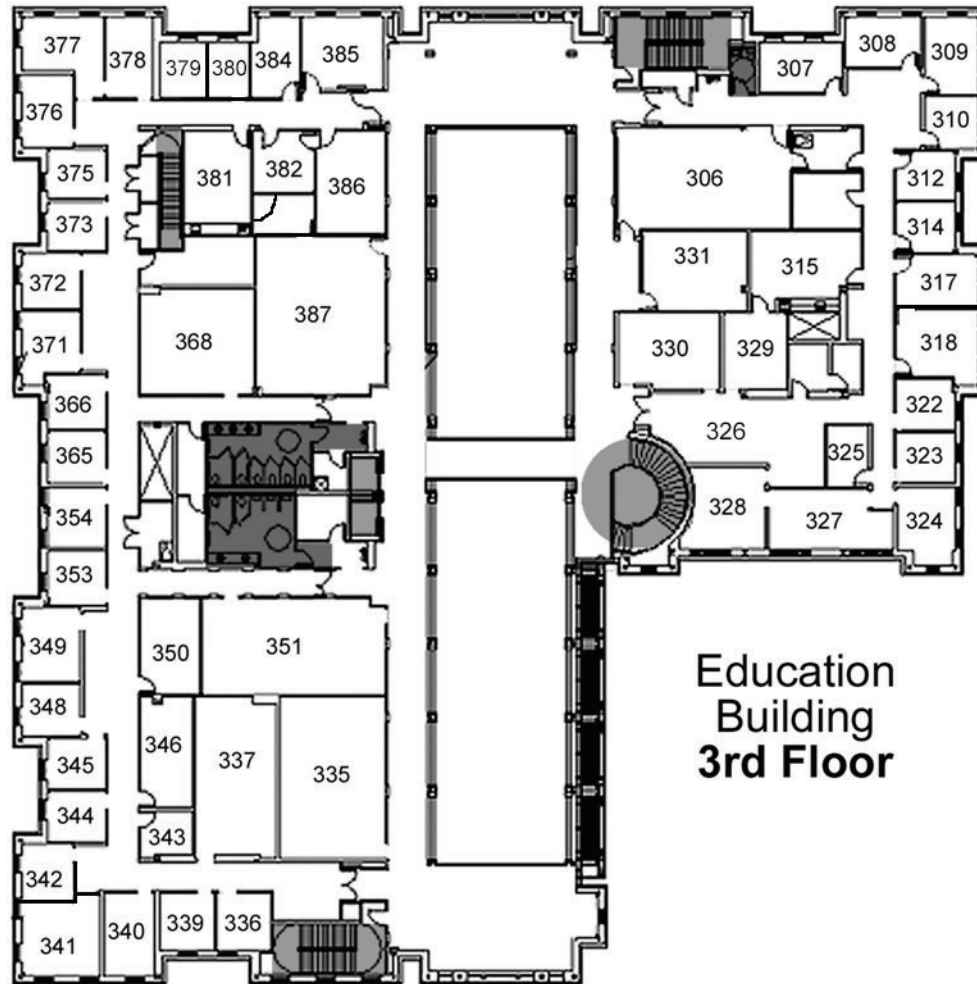

**Education
Building
3rd Floor**